

IR Commander Matrix

keene Data Sheet

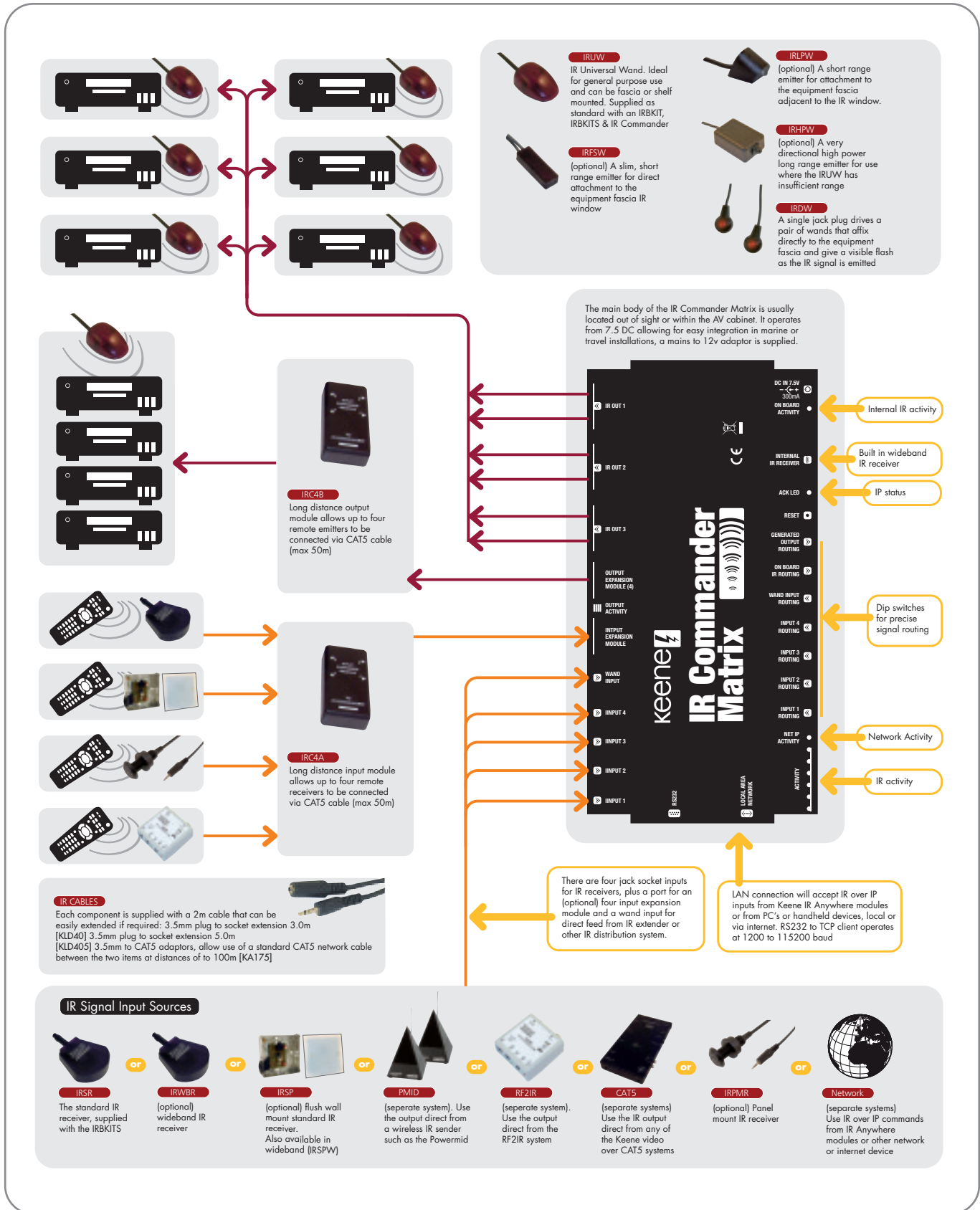

IR Commander Matrix



keene
Data Sheet 



IR Commander Matrix IRCM

The most advanced and the most capable IR distribution system we've ever produced!

- **Full Matrix Signal Routing** - Each IR input can be routed to any combination of IR outputs. This means for example an equipment cabinet could house say three identical Sky receivers, and each one can be controlled independently from different rooms.
- **Four IR output channels** - each IR output channel can drive IR emitter wands or slave IR distribution amplifiers.
- **Six local IR input channels** - Four IR receivers, one on-board IR receiver and one wand input for taking the output directly from another IR distribution system or video sender.
- **IP addressable** - Will accept IR over IP inputs from Keene IR Anywhere modules or from PC's or handheld devices, up to 253 different IP addresses.
- **Internal IR command store** - Can store up to 64 IR codes in local memory, these can then be triggered by IP command from local network or internet.
- **Network inputs can be routed based on IP address** - Maximum flexibility for LAN devices.
- **Built in wideband IR receiver** - May be disabled if required.
- **Local inputs are "one way IRDA" compatible** - Will route signals to control all popular set top boxes.
- **Will act as Dynamic DNS update client** - Built in support for non-static WAN IP addresses.
- **LEDs indicate which input is active** - When IR activity is detected on one input all other inputs are momentarily blanked to ensure the signal remains pure and is cleanly transmitted. (the LEDs may be disabled if required)
- **Expansion module sockets for inputs and outputs** - Allows an additional 4 input or output module to be connected via CAT5 cable at a distance of up to 50m.